

ORLEANS COUNTY
TOWN OF BARRE

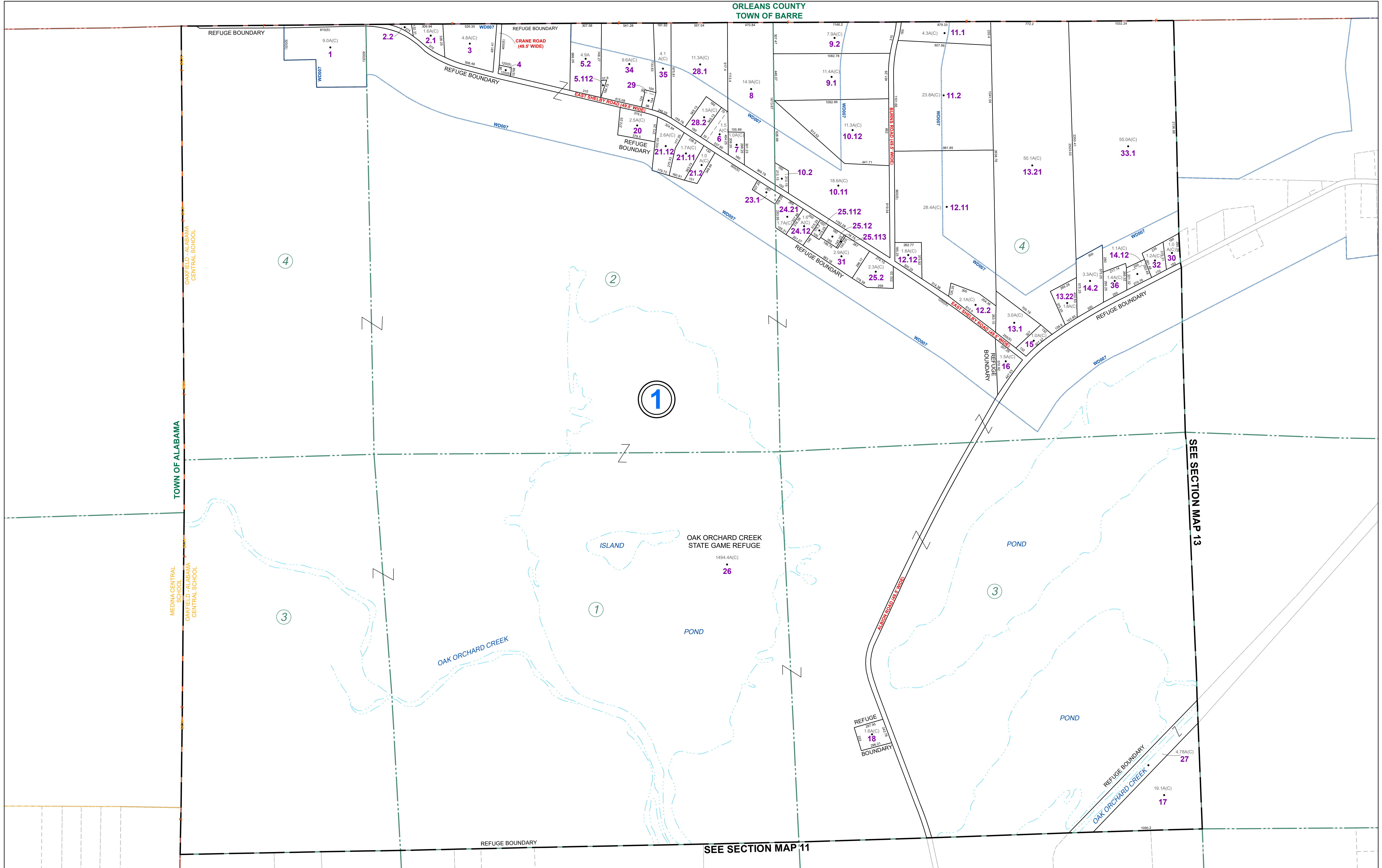

THIS MAP WAS PREPARED FOR TAX PURPOSES ONLY AND IS NOT TO BE REPRODUCED OR USED FOR SURVEYING OR CONVEYANCING.

PREPARED BY
McINTOSH & McINTOSH, LAND SURVEYORS
BATAVIA, NEW YORK
LAND SURVEYORS
OR
GENESEE COUNTY BOARD OF SUPERVISORS
Data converted to digital format August 2004, by Water Mapping
Map created using GCPM. Copyright 2007, Benjamin Associates

REVISION TABLE		
DATE	MADE BY	CHANGES OR ADDITIONS
01/17/2017	JRG	MERGE 14-1-5.111 & 5.12 INTO 14-1-5.121
01/24/2017	JRG	MERGE 14-1-22 & 23 INTO 14-1-23.1
08/05/2021	JRG	SPLIT 14-1-14.111 INTO 14-1-32 & 33
01/25/2022	JRG	SPLIT 14-1-5.121 INTO 14-1-34 & 35
02/17/2023	JRG	SPLIT 14-1-10.1 INTO 14-1-10.11 & 10.12
02/09/2024	JRG	SPLIT 14-1-33 INTO 14-1-33.1 & 33.2
02/09/2024	JRG	MERGE 14-1-14.112 & 33.2 INTO 14-1-36

SPECIAL DISTRICTS	
FIRE	OAKFIELD FIRE PROTECTION DISTRICT
SCHOOL	OAKFIELD-ALABAMA CENTRAL
WATER	OAKFIELD WATER DISTRICT # 7

PROPERTY LINE	---
ORIGINAL LOT LINE	---
RAILROAD	—+—+—
STREAM OR DITCH	—+—+—
ROAD OR RAILROAD BNDY	—+—+—
BLOCK LIMIT	---
GREAT LOT LINE	---
DENOTE COMMON OWNER	---

LEGEND	
SCHOOL DISTRICT LINE	---
FIRE DISTRICT LINE	---
WATER DISTRICT LINE	---
SEWER DISTRICT LINE	---
EASEMENT	---

TAX MAP BLOCK No	④
TAX MAP PARCEL No	43-14-11
FILED PLAN LOT No	14
GREAT LOT No	(9)
CALCULATED ACREAGE	7.5 A (C)
DEED ACREAGE	17.5 A
SCALED DIMENSION	225 (8)
DEED DIMENSION	173.8

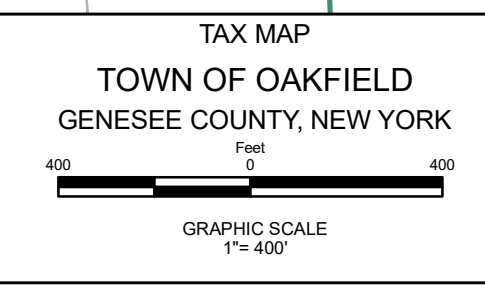
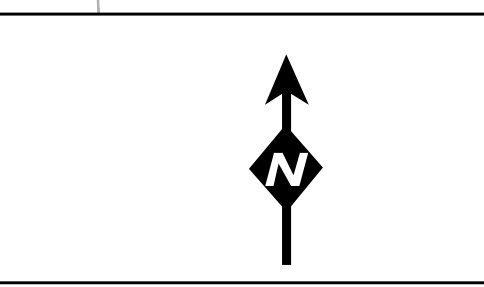

SECTION 14

MAP DATE: March 2024